



Printable pdf instruction

<https://buschmanntools.com/Falzcutter/eng>

Our links

<https://buschmanntools.com/>

<https://www.facebook.com/Buschmanntools/>

<https://www.instagram.com/buschmanntools/>



Homepage



Instagram



Facebook



FALZ CUTTER

ENG

Falz Cutter is intended for double-lock standing seam metal roof dismantling. It dissects double-lock standing seam connection places.

Falz Cutter can be positioned at any double-locked standing seam point which makes it possible not only to remove connection places of the roof, but to cut out area for various types of needs for example ventilation shafts and roof windows.

TECHNICAL INFORMATION

MAX. THICKNESS

- STAINLESS STEEL: 0.5 mm
- ALUMINUM, COPPER, ZINC: 0.8 mm
- STEEL: 0.7 mm

MAX. SPEED

- 20 m / min

Video instruction



PREMIUM DESIGN

- Easy maintenance
- Excellent durability
- Precise maneuvering
- Cut complex areas
- Lightweight



RECOMMEND cordless drill with a torque of 110 N m and more
Minimum torque of 60 N m for soft roof segment



Protected by Military grade case containing safety foam

IP67 RATING **MIL SPECS** DEF STAN 81-41 STANAG 4280

CORDLESS DRILL SETUP

ENG

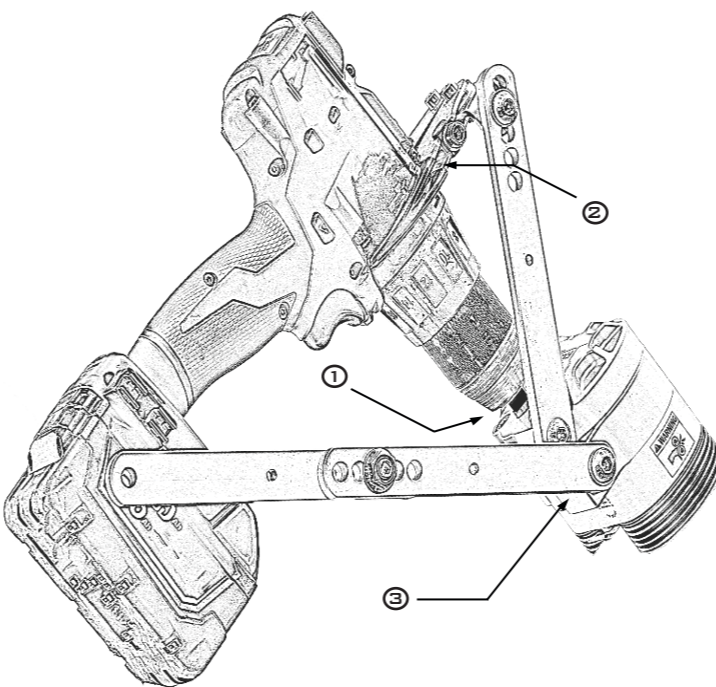

For setting up the FALZ CUTTER ensure that accumulator is removed from the cordless drill

For work condition put accumulator into the cordless drill only after ensuring that Falz cutter is connected properly according to the users manual.

- 1 Position the cordless drill on the 10 mm rotating hex cap head axle and tighten it
- 2 Tighten the cordless drill inside the Holder with the provided Allen key. The holder must be tightened until the holder sides stops against the cordless drill.
- 3 Adjust and tighten the support bars. One side must be positioned right by the Falz Cutter specific side and other side must adjusted right by the cordless drill in angle so the support bars stop by Accumulator of the cordless drill.

BEFORE INSERTING THE ACCUMULATOR IN CORDLESS DRILL MACHINE, READ THE MANUAL

"IMPORTANT SAFETY INFORMATION FOR OPERATING THE FALZ CUTTER"

CORRECT USAGE

ENG

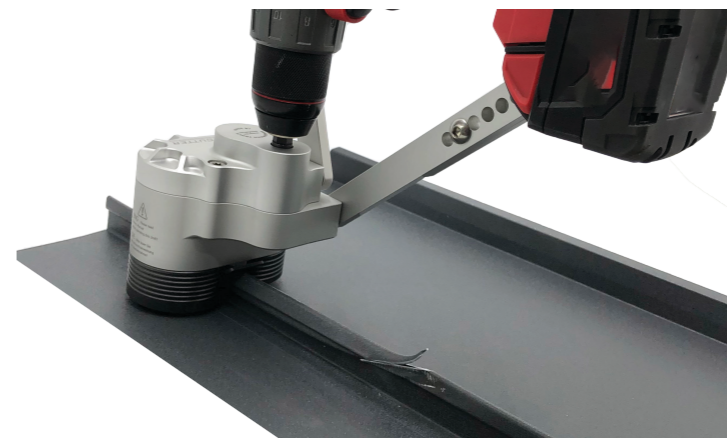

USE CORRECT POSITION

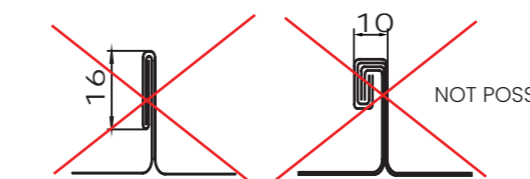
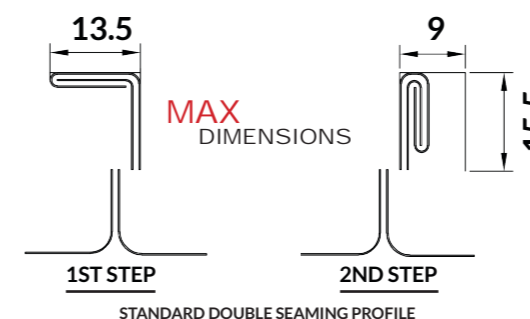
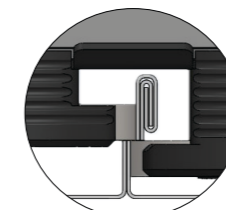

IMPORTANT SAFETY INFORMATION FOR OPERATING THE FALZ CUTTER

ENG

- Always make sure to remove the accumulator from the cordless drill for setting up the tool
- When performing a task that's not associated with the cutting operation the accumulator must be removed from the cordless drill!
- Carefully read all safety information before operating the FALZ CUTTER and save it for future reference.
- As a matter of principle, any person who is put in charge with the start-up, operation, maintenance and repair of the machine must have read and understood the operating instructions, specifically the chapter on safety.
- When working with FALZ CUTTER on a roof, always use roof lifeline and follow all safety regulations
- Before using FALZ CUTTER for the first time, carefully remove all packing materials. Always make sure that FALZ CUTTER is properly assembled before using.
- During the work hold hands, fingers, hair, clothes and other tools at a safe distance. Never place your hands, fingers or tools between the discs.
- Do not overreach. Keep proper footing and balance at all times.
- Stay alert. Watch what you are doing. Use common sense. Do not operate tool when you are tired or under the influence of drugs, alcohol or medication. A moment of inattention while operating may result in serious personal injury.
- Do not wear loose clothing or jewellery. Keep your hair, clothing, and gloves away from moving parts. Loose clothes, jewellery or long hair can be caught in moving parts.
- After using FALZ CUTTER, make sure that the tool isn't wet and then placed in the box. If sand and dust accumulate around the discs, clean them.
- Do not expose the FALZ CUTTER to extreme temperatures, it is not recommended to operate the device in cold weather (below zero degrees). Do not expose FALZ CUTTER to rain or use it under moist or wet condition.
- This tool is not intended for use by children. Ensure that children do not have access to the FALZ CUTTER.
- When FALZ CUTTER and accessories are not in use, keep them in a safe place.
- It is strictly forbidden to put and keep a wet FALZ CUTTER in a case.

OPERATING INSTRUCTION OF FALZ CUTTER

- The FALZ CUTTER is to be operated exclusively by qualified and authorised persons who must know the national accident-prevention rules.
- Obligated to check the FALZ CUTTER for externally visible damage and defects before starting work and to notify and eliminate any changes (including the operation behavior) that affect the safety.
- Sight-checking all screws- tighten screws if necessary.
- Position the Falz Cutter with the cordless drill machine
- Check if the roof dimensions of profile are within the maximum allowable dimensions, see "Correct usage" page.
- In order for Falz Cutter to work properly Cordless drill speed must be set at 1 (500-550 RPM)
- If a profile is needed to be cut by full length then cutting discs must be placed at the beginning of the metal roof (each cutting disc must on different side) And start the cutting process. (Make sure that the profile side is on the left side)
- If it's necessary to start the cutting process from the middle of the profile then place the Falz Cutter on the profile (each cutting disc must be on different side) Tilt the cordless drill machine by 20 - 30 degrees and start the cutting process. Tilting the cordless drill machine by 20 - 30 degrees to the opposite side the Falz Cutter can be detached. (For this option we recommend powerfull cordless drill machine) 110+ N m
- The Cordless drill works clockwise and Falz Cutter is operating in forwards direction

! DO NOT let comfort or familiarity with product (gained from repeated use) replace strict adherence to safety rules for the subject product. MISUSE or failure to follow the safety rules stated in this instruction manual may cause serious personal injury !

POSSIBLE OPERATION FAILURE PREVENTION

ENG

- If the cordless drill is making TRRRRRRRRRRRRR sound make sure that the cordless drill machine is in drilling option (not the screwing option)
- If the Falz Cutter is not going forwards and is jammed, then possibly falz profile is thicker than 9 mm
- If the cordless drill gets hot and can't withstand the load then possibly metal profile height is above the maximum allowable height
- Make sure you're not using impact driver!

CARE, MAINTENANCE AND STORAGE OF FALZ CUTTER

- Always make sure the battery is disconnected from the cordless drill and only then clean the tool!
- Clean the device every time after using it.
- Clean FALZ CUTTER from moisture, dust and sand.
- Always keep gears clean.
- Keep the rotary parts free from dust, sand and moisture.
- Check all screws periodically.
- It is strictly forbidden to put and keep a wet or damp FALZ CUTTER in a case.

WARRANTY

We guarantee that all FALZ CUTTER is made of high-quality materials and does not have any manufacturing defects. In case your device turns up the following defects, we will eliminate them in accordance with the law free of charge. Therefore, we give 1 (one) year limited warranty on our tools from the date of invoice. Limited warranty applies only to first sale. You must contact the company that has sold the product to file claims. Be sure that You have the purchase document! The device must be delivered for repair in a complete set.

If FALZ CUTTER is repaired by an unqualified person, we can no longer guarantee the quality of the device. Also, we can not guarantee the quality of the device if:

- the tool is mechanically damaged, dropped off or otherwise broken;
- have been used on incorrect working methods;
- have been used with unsuitable accessories;
- the tool is used for unforeseen purposes;
- the tool is used after detection of a defect;
- the tool used by a person without the necessary skills;
- the tool was uncared for;
- the construction and parameters of the tool have been changed.

The FALZ CUTTER is a complex combination of mechanical parts and has a lot of moving and wearing off parts. Wearing off parts is a normal phenomenon, not a production defect. In result of normal usage, worn parts will not be exchanged for free. Make sure the Device Model and Serial Number and Date of Purchase are correctly marked on the Purchase Document.

ENJOY YOUR FALZ CUTTER