

DESCRIPTION AND SPECIFICATIONS

The DOUBLE FALZ SEAMER is the perfect hand-held equipment for perfect and effortless seaming of single and double standing-seam in one operation.

TECHNICAL DATA

TOOL MAX SPEED

- 30 m / min
- 100 m² / 7 min

DRIVER/DRILL REQUIREMENTS

MIN. TORQUE

- 60 N m (535 in./lb.) for soft roof material

RECOMMENDED TORQUE

- 110 N m (975 in./lb.)

MAX. TORQUE

- 150 N m (1325 in./lb.)

! Do not use impact driver or hammer drill mode while operating this tool.

PROFILE SPECIFICATIONS

MAX THICKNESS

- STAINLESS STEEL: 0.5 mm (26ga.)
- ALUMINUM, COPPER, ZINC: 0.8 mm (20ga.)
- STEEL: 0.7 mm (24ga.)

DEVELOPED FOR STANDARD 25 & 38 MM PROFILE

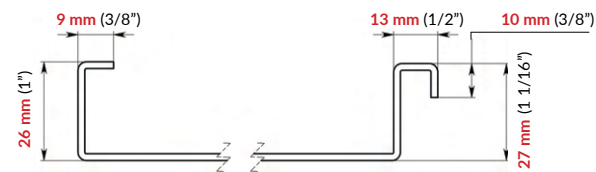

*Standard 25 mm profile (1") dimensions (for reference only)

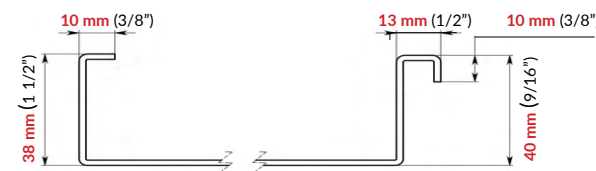

*Standard 38 mm profile (1.5") dimensions (for reference only)

SETUP INSTRUCTIONS

SETUP THE CORDLESS DRILL HANDLE

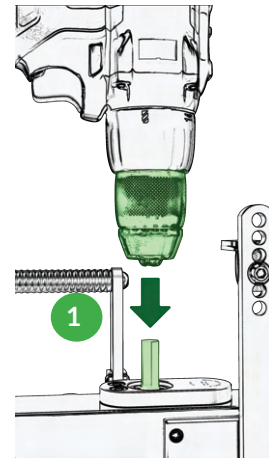

1. Position the cordless drill on the 10 mm hex cap head axle and tighten it.

2. Securely fasten the cordless drill inside the Holder. Tighten the holder until its sides make firm contact with the cordless drill.

3. Adjust and tighten the support bar.

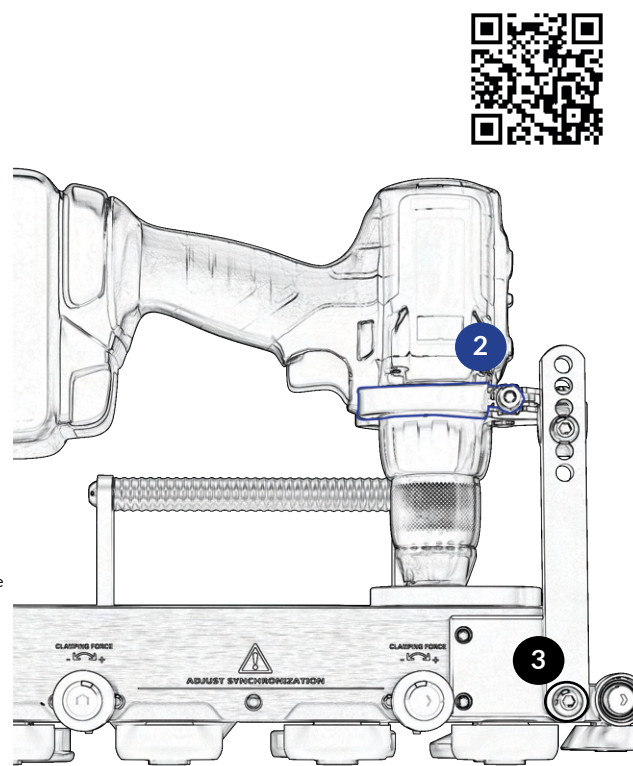

SEAMING PRESSURE ADJUSTMENT

- Locate the seaming pressure adjustment knobs on your machine.
- To **increase** the pressure, rotate both knobs clockwise.
- To **reduce** the pressure, rotate both knobs counter-clockwise.
- Ensure that you adjust the seaming pressure **equally** on both sides.

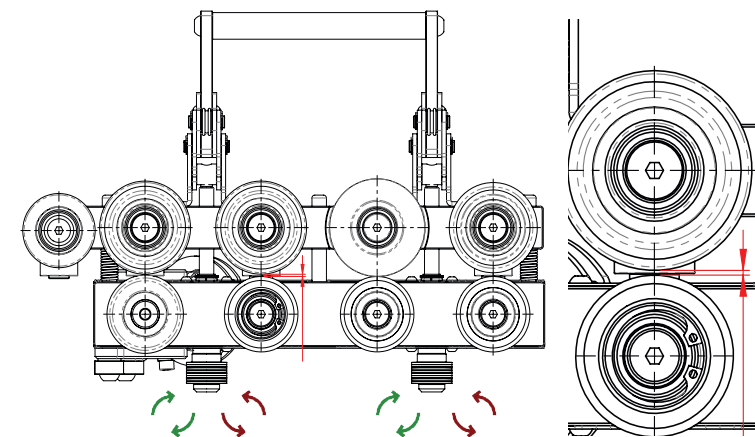

Adjustment reference
factory default setting
0 mm

OPERATION - ON ROOF - DOUBLE STEP

Use seam folders at the beginning of the profile

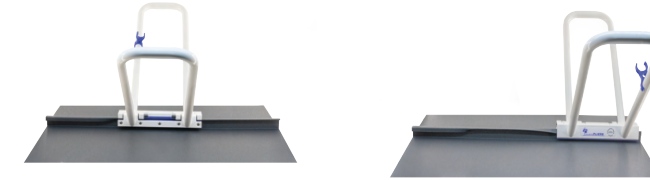

1. Use twin square seam folder twice (1st step)
2. Use twin square seam folder once (2nd step)



Plastic Pliers

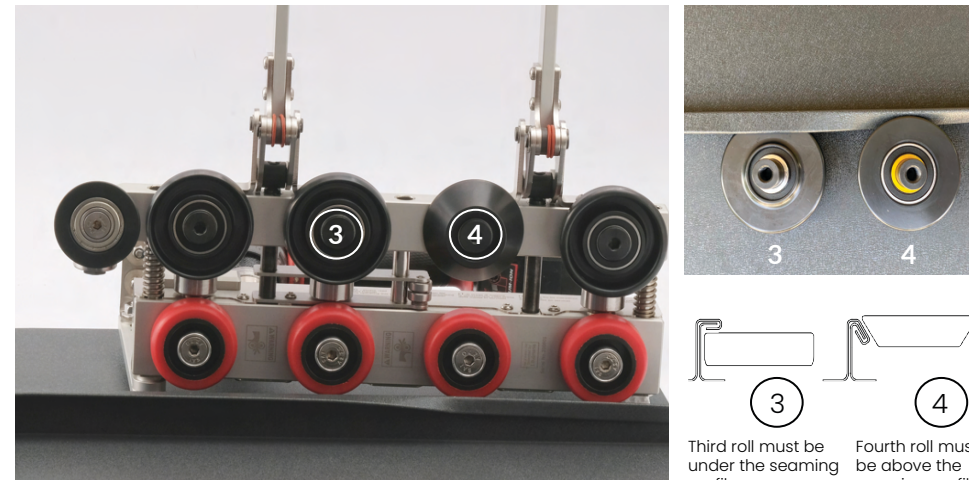

Third roll must be under the seaming profile
Fourth roll must be above the seaming profile

4. Make sure the 3rd roll is below the seam and 4th roll is above the seam

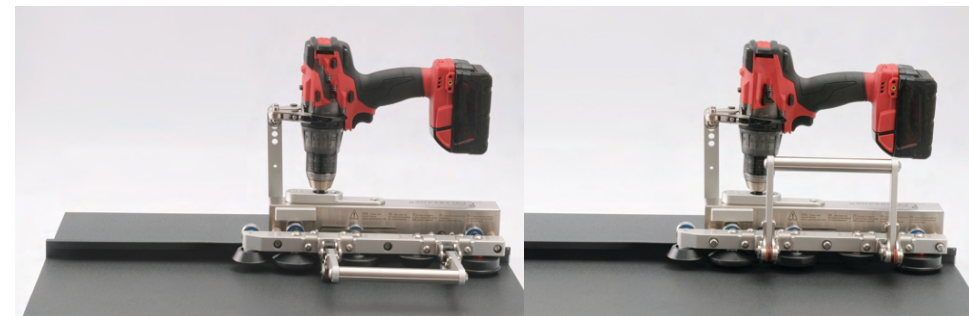

5. Position the Double Falz Seamer on the seam with an open handle and then close the Double Falz Seamer and start seaming! Double Falz Seamer is attachable on any place in to the seam

OPERATION - ON FACADE - SINGLE STEP

To form a 1 stage seam, remove forming rollers 4 and 5



1. If its necessary only to do single step, you need to unscrew 4 and 5 roll off and you can start seaming!

1ST STAGE

- Use only rolls 1, 2 and 3.

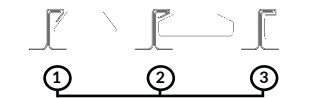

Facade / Single step

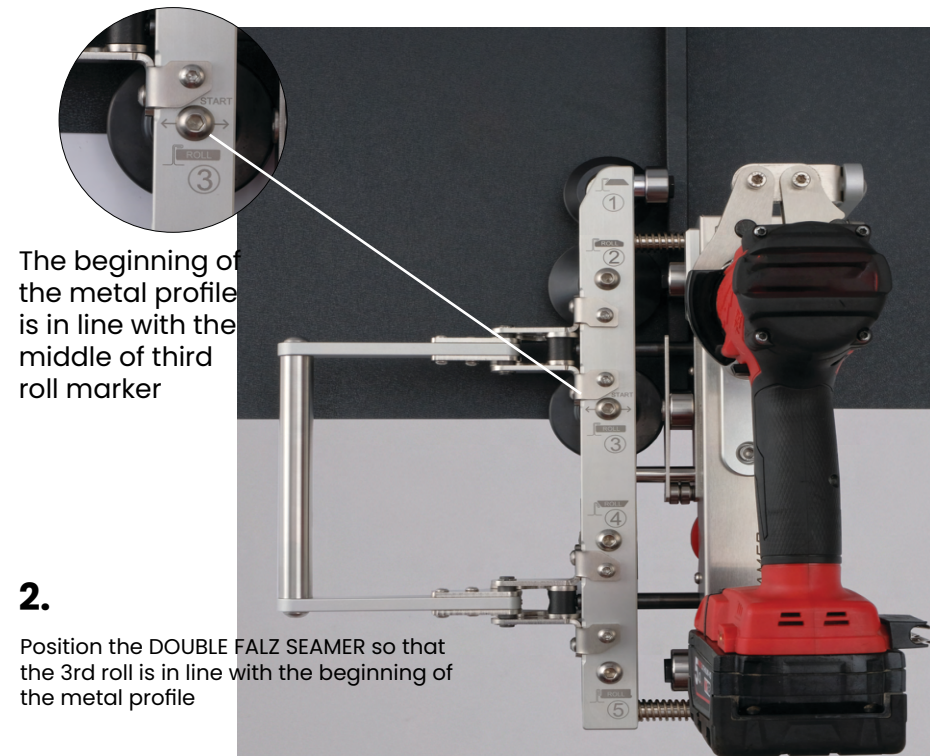

The beginning of the metal profile is in line with the middle of third roll marker

2. Position the DOUBLE FALZ SEAMER so that the 3rd roll is in line with the beginning of the metal profile

DISCOVER ESSENTIALS



FALZBENDER



PERFECT BENDER



FALZSEAMER II
STEPS



PLASTIC PLIERS



FALZ CUTTER



PIPEXPAND PRO



PROHIBITED USE

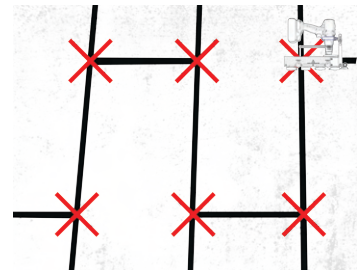

Do not seam roofs with roofing panels that are stacked lengthwise. Seaming over multiple layers of roofing may damage the tool due to the increased material thickness.

SAFETY INFORMATION

- Before setting up the tool always make sure to remove the accumulator from the cordless drill!
- When performing operation that's not associated with the seaming task the accumulator must be removed from the cordless drill!
- Carefully read all safety information before operating the DOUBLE FALZ SEAMER and save it for future reference.
- As a matter of principle, any person who is put in charge with the start-up, operation, maintenance and repair of the machine must have read and understood the operating instructions, specifically the chapter on safety.
- When working with DOUBLE FALZ SEAMER on a roof, always use roof lifeline and follow all safety regulations, as the DOUBLE FALZ SEAMER with a cordless drill machine is a very fast tool.
- Before using DOUBLE FALZ SEAMER for the first time, carefully remove all packing materials.
- Always make sure that DOUBLE FALZ SEAMER is properly assembled before using.
- Always make sure the battery is disconnected from the DOUBLE FALZ SEAMER's cordless drill machine and only then clean the tool or replace the rolls.
- During the work hold hands, fingers, hair, clothes and other tools at a safe distance. Never place your hands, fingers or tools between the rolls.
- Do not overreach. Keep proper footing and balance at all times.
- Stay alert. Watch what you are doing. Use common sense. Do not operate tool when you are tired or under the influence of drugs, alcohol or medication. A moment of inattention while operating may result in serious personal injury.
- Do not wear loose clothing or jewellery. Keep your hair, clothing, and gloves away from moving parts. Loose clothes, jewellery or long hair can be caught in moving parts.
- After using DOUBLE FALZ SEAMER, make sure that the tool isn't wet and then put it in the box. If sand and dust accumulate around the rollers, clean them.
- Keep the tool clean. For more information on maintenance and cleaning, see on page 7.
- Do not expose the DOUBLE FALZ SEAMER extreme temperatures, it is not recommended to operate the device in cold weather (below zero degrees). Do not expose DOUBLE FALZ SEAMER to rain or use it under moist or wet condition.
- This tool is not intended for use by children. Ensure that children do not have access to the DOUBLE FALZ SEAMER.
- When Double Falz Seamer and accessories are not in use, keep them in a safe place.
- It is strictly forbidden to put and keep a wet DOUBLE FALZ SEAMER in a case.

GENERAL INFORMATION AND WARRANTY

OPERATING INSTRUCTION

- The DOUBLE FALZ SEAMER is to be operated exclusively by qualified and authorised persons who must know the national accident-prevention rules.
- Carefully remove packaging and all promotional labels before using DOUBLE FALZ SEAMER for the first time.
- Wear adequate working clothes. Long hair should be protected by a hairnet. Put on protective gloves.
- Obligated to check the DOUBLE FALZ SEAMER for externally visible damage and defects before starting work and to notify and eliminate any changes (including the operation behavior) that affect the safety.
- Sight-checking all screws- tighten screws if necessary.

FAILURE PREVENTION

- if DOUBLE FALZ SEAMER does not work - make sure the drill battery is charged :)
- if rolls scratch color off the metal - make sure the work area is clean from sand, dust etc...
- if sound is not good while seaming - make sure the profile is correctly folded.
- if rotary rolls are starting to rust - after use the tool has not been carefully cleaned.
- if the tool stops - you can't use it on the specific place. If the cordless drill is powerful enough - it will withstand the force, but the tool will break, if the cordless drill is not powerful enough - it will break, but the tool will withstand the force.
- If the wheels are slipping than make sure that the surface is completely dry from any moisture

CARE, MAINTENANCE AND STORAGE

- Always make sure the battery is disconnected from the cordless drill and only then clean the tool!
- Clean the device every time after using it.
- Clean DOUBLE FALZ SEAMER from moisture, dust and sand.
- Always keep gears clean.
- Keep the rotary parts free from dust, sand and moisture.
- Check all screws periodically.
- It is strictly forbidden to put and keep a wet or damp Double Falz Seamer in a case.

WARRANTY

We guarantee that all DOUBLE FALZ SEAMER is made of high quality materials and does not have any manufacturing defects. In case your device turns up the following defects, we will eliminate them in accordance with the law free of charge. Therefore, we give 1 (one) year limited warranty on our tools from the date of invoice. Limited warranty applies only to first sale. You must contact the company that has sold the product to file claims. Be sure that You have the purchase document! The device must be delivered for repair in a complete set.

If DOUBLE FALZ SEAMER is repaired by an unqualified person, we can no longer guarantee the quality of the device. Also, we can not guarantee the quality of the device if:

- the tool is mechanically damaged, dropped off or otherwise broken;
- have been used on incorrect working methods;
- have been used with unsuitable accessories;
- the tool is used for unforeseen purposes;
- the tool is used after detection of a defect;
- the tool used by a person without the necessary skills;
- the tool was uncared for;
- the construction and parameters of the tool have been changed.

The DOUBLE FALZ SEAMER is a complex combination of mechanical parts and has a lot of moving and wearing off parts. Wearing off parts is a normal phenomenon, not a production defect. In result of normal usage, worn parts will not be exchanged for free. Wearing parts are for example: Handle, Protectors, Chain, Wheels, Gear Drive Shaft, PVC Gears, PVC Case and all other moving Parts.

SKU#0600

WEIGHT 5.7KG

ENG



DOUBLE
FALZSEAMER

BUSCHMANN TOOLS
INVENTION
PRODUCTION
MADE BY